

Adj Abram Clark

White oak Beg. 1779

Adj Edm<sup>d</sup> Gibson

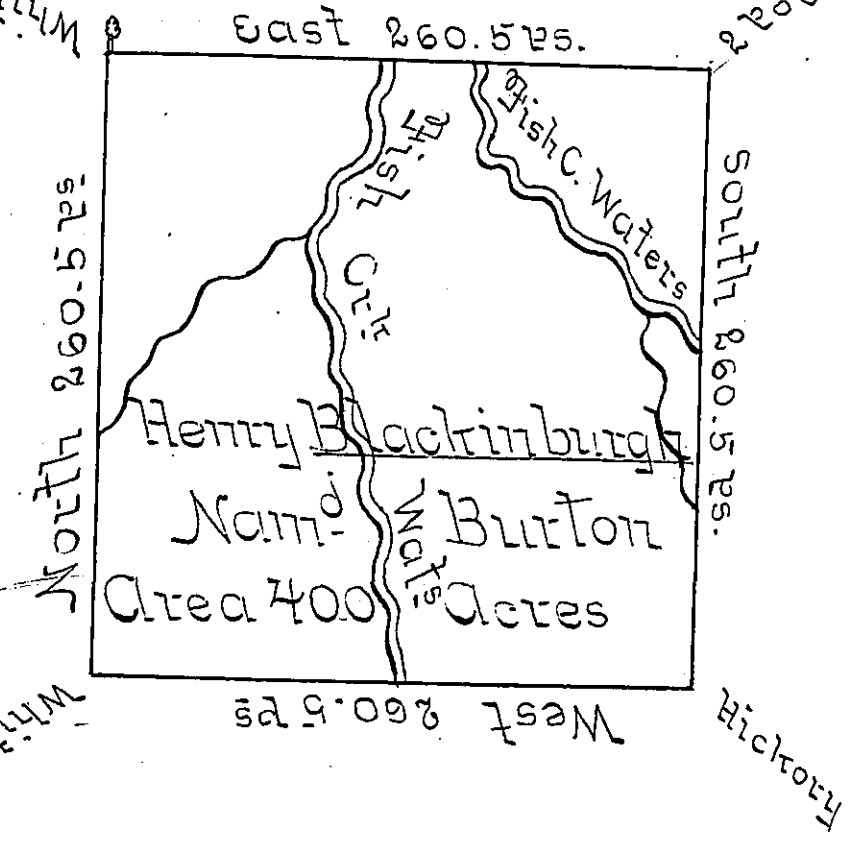

Adj John Stiles

Adj Rich<sup>d</sup> Pennan

The Above is a Draught of a Survey Made the 5<sup>th</sup> Day of Feb<sup>r</sup> 1785. in pursuance of a Warrant granted to Henry Blackinburg Dated the 25<sup>th</sup> Day of Oct<sup>r</sup> 1784 situate on a Branch of Fish Crick in Washington County & Called Nam<sup>d</sup> Burton Containing four hundred Acres With Usall Allowance of 6<sup>th</sup> Cent for Roads &

Jno Hoge D.S.

To John Lukens Esq<sup>r</sup> Surv<sup>r</sup> Gen<sup>l</sup>

IN TESTIMONY that the above is a copy of the original remaining on file in the Department of Internal Affairs of Pennsylvania, made conformably to an Act of Assembly approved the 16th day of February, 1833, I have hereunto set my Hand and caused the Seal of said Department to be affixed at Harrisburg, this — sixth — day of — August — 1901. —

*James W. Latta*  
 Secretary of Internal Affairs.